

Spojovací a montážní materiál pro izolátory DB/P, CO/P, CS/P, CT/P, CPE a držáky sběrnic PSB

Svorník se závitem pro izolátory

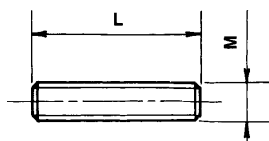

| M | x | L (mm) | Objednáací číslo |
|----|---|--------|------------------|
| 3 | x | 12 | 90270 |
| 3 | x | 15 | 90271 |
| 4 | x | 15 | 90272 |
| 4 | x | 16 | 90273 |
| 4 | x | 18 | 90274 |
| 4 | x | 20 | 90275 |
| 5 | x | 20 | 90276 |
| 5 | x | 22 | 90277 |
| 5 | x | 27 | 90278 |
| 5 | x | 30 | 90279 |
| 6 | x | 18 | 90280 |
| 6 | x | 20 | 90281 |
| 6 | x | 25 | 90282 |
| 6 | x | 27 | 90283 |
| 6 | x | 33 | 90284 |
| 6 | x | 35 | 90285 |
| 8 | x | 20 | 90286 |
| 8 | x | 23 | 90287 |
| 8 | x | 25 | 90288 |
| 8 | x | 30 | 90289 |
| 8 | x | 33 | 90290 |
| 8 | x | 35 | 90291 |
| 8 | x | 38 | 90292 |
| 8 | x | 50 | 90293 |
| 10 | x | 30 | 90294 |
| 10 | x | 35 | 90295 |
| 10 | x | 38 | 90296 |
| 10 | x | 40 | 90297 |
| 10 | x | 45 | 90298 |
| 10 | x | 50 | 90299 |
| 12 | x | 30 | 90300 |
| 12 | x | 50 | 90301 |
| 16 | x | 40 | 90326 |
| 16 | x | 60 | 90327 |

Šestihranné distanční sloupky, pozinkované pro izolátory

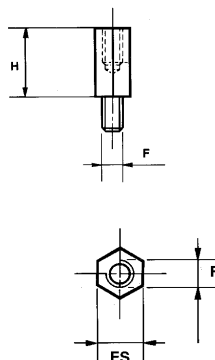

| H | F (mm) | ES. | Objednáací číslo |
|----|--------|-----|------------------|
| 15 | M 4 | 7 | 90330 |
| 20 | M 4 | 7 | 90331 |
| 25 | M 4 | 7 | 90332 |
| 30 | M 4 | 7 | 90333 |
| 50 | M 4 | 7 | 90334 |
| 70 | M 4 | 7 | 90335 |
| 90 | M 4 | 7 | 90336 |
| 15 | M 5 | 8 | 90337 |
| 20 | M 5 | 8 | 90338 |
| 25 | M 5 | 8 | 90339 |
| 30 | M 5 | 8 | 90340 |
| 50 | M 5 | 8 | 90341 |
| 70 | M 5 | 8 | 90342 |
| 90 | M 5 | 8 | 90343 |
| 15 | M 6 | 10 | 90344 |
| 20 | M 6 | 10 | 90345 |
| 25 | M 6 | 10 | 90346 |
| 30 | M 6 | 10 | 90347 |
| 50 | M 6 | 10 | 90348 |
| 70 | M 6 | 10 | 90349 |
| 90 | M 6 | 10 | 90350 |
| 15 | M 8 | 13 | 90351 |
| 20 | M 8 | 13 | 90352 |
| 25 | M 8 | 13 | 90353 |
| 30 | M 8 | 13 | 90354 |
| 50 | M 8 | 13 | 90355 |
| 70 | M 8 | 13 | 90356 |
| 90 | M 8 | 13 | 90357 |

Svorník se závitem, 2 kusy podložek a matic

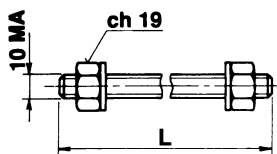

| M | x | L (mm) | Objednáací číslo |
|----|---|--------|------------------|
| 10 | x | 194 | 90318 |
| 10 | x | 230 | 90319 |
| 10 | x | 242 | 90320 |
| 10 | x | 270 | 90321 |
| 10 | x | | 90322 |
| 10 | x | 350 | 90323 |
| 10 | x | 410 | 90324 |
| 10 | x | 1000 | 90325 |

Šrouby se šestihrannou hlavou, podložkou a maticí

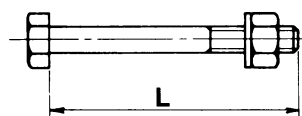

| M | x | L (mm) | Objednáací číslo |
|----|---|--------|------------------|
| 10 | x | 60 | 90309 |
| 10 | x | 80 | 90310 |
| 10 | x | 70 | 90311 |
| 10 | x | 90 | 90312 |
| 10 | x | 100 | 90313 |
| 10 | x | 110 | 90314 |
| 10 | x | 140 | 90315 |
| 10 | x | 150 | 90316 |
| 10 | x | 160 | 90317 |