

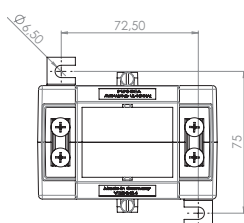

Primární pas 30 x 10 mm
20 x 13 mm
Primární vodič Ø 23 mm
Šířka 95 mm
Výška 116 mm

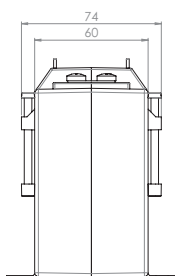
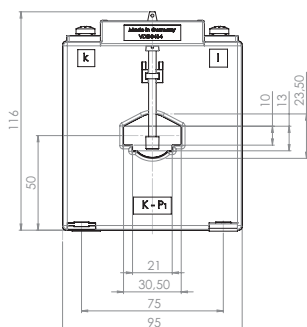

SASK 31.6

Jisticí transformátor proudu násuvný

Primární jmenovitý proud [A]	Jmenovitá zátěž [VA]	Sekundární proud [A] / Třída přesnosti		
		5 A tř. 5P5 Obj. číslo	5 A tř. 10P5 Obj. číslo	5 A tř. 5P10 Obj. číslo
50	1,5	S19-0906C	S19-0907C	
	2,5		S19-0907D	
60	1,5	S19-1006C	S19-1007C	
	2,5	S19-1006D	S19-1007D	
80	1,5			S19-1208C
	2,5	S19-1206D	S19-1207D	
	5	S19-1206F	S19-1207F	
100	1,5	S19-1306C	S19-1307C	S19-1308C
	2,5	S19-1306D	S19-1307D	
	5	S19-1306F	S19-1307F	
150	2,5	S19-1606D	S19-1607D	S19-1608D
	5	S19-1606F	S19-1607F	
200	2,5	S19-1706D	S19-1707D	S19-1708D
	5	S19-1706F	S19-1707F	S19-1708F
	7,5	S19-1706G	S19-1707G	
	10	S19-1706H	S19-1707H	
250	2,5	S19-1806D	S19-1807D	S19-1808D
	5	S19-1806F	S19-1807F	S19-1808F
	7,5	S19-1806G	S19-1807G	
300	10	S19-1806H	S19-1807H	
	2,5	S19-1906D	S19-1907D	S19-1908D
	5	S19-1906F	S19-1907F	S19-1908F
400	10	S19-1906H	S19-1907H	
	2,5	S19-2006D	S19-2007D	S19-2008D
	5	S19-2006F	S19-2007F	S19-2008F
	7,5	S19-2006G	S19-2007G	S19-2008G
500	10	S19-2006H	S19-2007H	S19-2008H
	15	S19-2006J	S19-2007J	
	2,5	S19-2106D	S19-2107D	S19-2108D
	5	S19-2106F	S19-2107F	S19-2108F
600	7,5	S19-2106G	S19-2107G	S19-2108G
	10	S19-2106H	S19-2107H	S19-2108H
	15	S19-2106J	S19-2107J	
	2,5	S19-2206D	S19-2207D	S19-2208D
750	5	S19-2206F	S19-2207F	S19-2208F
	7,5	S19-2206G	S19-2207G	S19-2208G
	10	S19-2206H	S19-2207H	S19-2208H
	15	S19-2206J	S19-2207J	
750	2,5	S19-2306D	S19-2307D	S19-2308D
	5	S19-2306F	S19-2307F	S19-2308F
	7,5	S19-2306G	S19-2307G	S19-2308G
	10	S19-2306H	S19-2307H	S19-2308H
750	15	S19-2306J	S19-2307J	



SASK 31.6

Jisticí transformátor proudu násuvný

Primární pas 30 x 10 mm
20 x 13 mm



Primární vodič Ø 23 mm

Šířka 95 mm

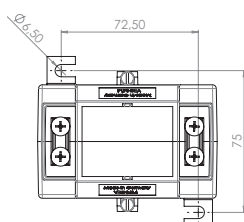
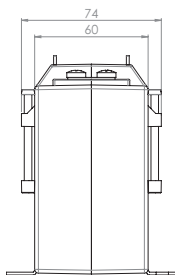
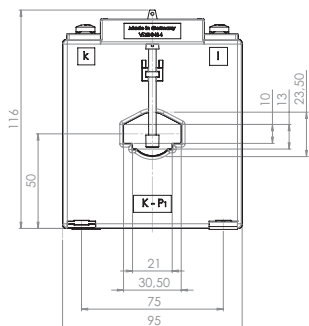
Výška 116 mm



Primární jmenovitý proud [A]	Jmenovitá zátěž [VA]	Sekundární proud [A] / Třída přesnosti			
		5 A tř. 10P10 Obj. číslo	5 A tř. 5P15 Obj. číslo	5 A tř. 10P15 Obj. číslo	
60	1,5	S19-1009C			
80	1,5	S19-1209C			
100	1,5	S19-1309C	S19-130AC	S19-130BC	
	2,5	S19-1309D			
150	2,5	S19-1609D	S19-160AD	S19-160BD	
200	2,5	S19-1709D	S19-170AD	S19-170BD	
	5	S19-1709F			
250	2,5	S19-1809D	S19-180AD	S19-180BD	
	5	S19-1809F			
300	2,5	S19-1909D	S19-190AD	S19-190BD	
	5	S19-1909F			
400	2,5	S19-2009D	S19-200AD	S19-200BD	
	5	S19-2009F	S19-200AF	S19-200BF	
	7,5	S19-2009G			
500	10	S19-2009H			
	2,5	S19-2109D	S19-210AD	S19-210BD	
	5	S19-2109F	S19-210AF	S19-210BF	
600	7,5	S19-2109G			
	10	S19-2109H			
	2,5	S19-2209D	S19-220AD	S19-220BD	
750	5	S19-2209F	S19-220AF	S19-220BF	
	7,5	S19-2209G			
	10	S19-2209H			
750	2,5	S19-2309D	S19-230AD	S19-230BD	
	5	S19-2309F	S19-230AF	S19-230BF	
	7,5	S19-2309G			
		10	S19-2309H		

		Obj. číslo
	Příchytka na DIN lištu	-
	Plombovací krytka E	59044



Primární pas 30 x 10 mm
20 x 13 mm
Primární vodič Ø 23 mm
Šířka 95 mm
Výška 116 mm

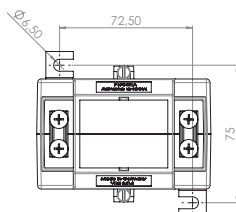
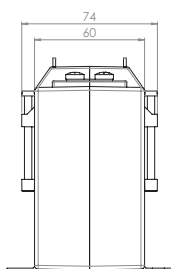
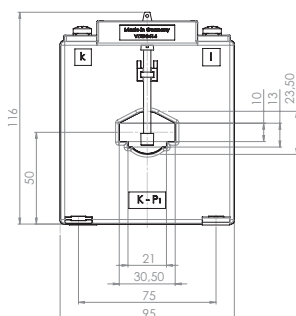

SASK 31.6

Jisticí transformátor proudu násuvný

Primární jmenovitý proud [A]	Jmenovitá zátěž [VA]	Sekundární proud [A] / Třída přesnosti		
		1 A tř. 5P5 Obj. číslo	1 A tř. 10P5 Obj. číslo	1 A tř. 5P10 Obj. číslo
50	1,5	S19-0916C	S19-0917C	
	2,5		S19-0917D	
60	1,5	S19-1016C	S19-1017C	S19-1018C
	2,5	S19-1016D	S19-1017D	
80	1,5	S19-1216C	S19-1217C	S19-1218C
	2,5	S19-1216D	S19-1217D	S19-1218D
	5		S19-1217F	
100	2,5	S19-1316D	S19-1317D	S19-1318D
	5	S19-1316F	S19-1317F	
150	2,5	S19-1616D	S19-1617D	S19-1618D
	5	S19-1616F	S19-1617F	
200	2,5	S19-1716D	S19-1717D	S19-1718D
	5	S19-1716F	S19-1717F	S19-1718F
	7,5	S19-1716G	S19-1717G	
250	2,5	S19-1816D	S19-1817D	S19-1818D
	5	S19-1816F	S19-1817F	S19-1818F
	7,5	S19-1816G	S19-1817G	
300	2,5	S19-1916D	S19-1917D	S19-1918D
	5	S19-1916F	S19-1917F	S19-1918F
	10	S19-1916H	S19-1917H	
400	2,5	S19-2016D	S19-2017D	S19-2018D
	5	S19-2016F	S19-2017F	S19-2018F
	7,5	S19-2016G	S19-2017G	S19-2018G
	10	S19-2016H	S19-2017H	S19-2018H
500	2,5	S19-2116D	S19-2117D	S19-2118D
	5	S19-2116F	S19-2117F	S19-2118F
	7,5	S19-2116G	S19-2117G	S19-2118G
	10	S19-2116H	S19-2117H	S19-2118H
	15	S19-2116J	S19-2117J	
600	2,5	S19-2216D	S19-2217D	S19-2218D
	5	S19-2216F	S19-2217F	S19-2218F
	7,5	S19-2216G	S19-2217G	S19-2218G
	10	S19-2216H	S19-2217H	S19-2218H
750	2,5	S19-2316D	S19-2317D	S19-2318D
	5	S19-2316F	S19-2317F	S19-2318F
	7,5	S19-2316G	S19-2317G	S19-2318G
	10	S19-2316H	S19-2317H	S19-2318H
	15	S19-2316J	S19-2317J	



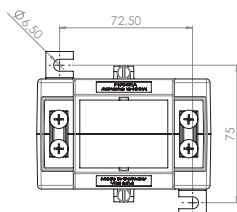
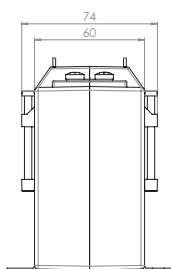
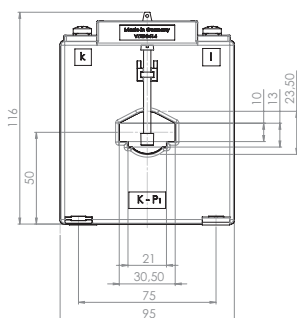

Primární pas 30 x 10 mm
20 x 13 mm
Primární vodič Ø 23 mm
Šířka 95 mm
Výška 116 mm



SASK 31.6

Jisticí transformátor proudu násuvný

Primární jmenovitý proud [A]	Jmenovitá zátěž [VA]	Sekundární proud [A] / Třída přesnosti			
		1 A tř. 10P10 Obj. číslo	1 A tř. 5P15 Obj. číslo	1 A tř. 10P15 Obj. číslo	
60	1,5	S19-1019C			
80	1,5	S19-1219C			
	2,5	S19-1219D			
100	1,5		S19-131AC	S19-131BC	
	2,5	S19-1319D			
150	2,5	S19-1619D	S19-161AD	S19-161BD	
200	2,5	S19-1719D	S19-171AD	S19-171BD	
	5	S19-1719F			
250	2,5	S19-1819D	S19-181AD	S19-181BD	
	5	S19-1819F			
300	2,5	S19-1919D	S19-191AD	S19-191BD	
	5	S19-1919F			
400	2,5	S19-2019D	S19-201AD	S19-201BD	
	5	S19-2019F	S19-201AF	S19-201BF	
	7,5	S19-2019G			
	10	S19-2019H			
500	2,5	S19-2119D	S19-211AD	S19-211BD	
	5	S19-2119F	S19-211AF	S19-211BF	
	7,5	S19-2119G			
600	10	S19-2119H			
	2,5	S19-2219D	S19-221AD	S19-221BD	
	5	S19-2219F	S19-221AF	S19-221BF	
	7,5	S19-2219G			
750	10	S19-2219H			
	2,5	S19-2319D	S19-231AD	S19-231BD	
	5	S19-2319F	S19-231AF	S19-231BF	
	7,5	S19-2319G			
		10	S19-2319H		

		Obj. číslo
	Příchytka na DIN lištu	-
	Plombovací krytka E	59044