



Standard Cable Glands with Thread, Stainless Steel

Stainless steel cable glands with lamellar clamping

- For high quality machines and housings.
- For high quality applications in corrosive environments.
- Applications: Outdoor, food industry, pharmaceutical industry and other sensitive applications.
- Easy assembly: install cable gland - insert cable - tighten cap.
- High quality strain relief and sealing, reliable performance for standard industrial applications.
- Up-to-date international approvals.

Technical Details		
Material	Body, Cap	Stainless steel 1.4305 (AISI 303)
	Seal	CR (Chloroprene)
	Clamping Insert	PA 6 (Polyamide 6)
	O-Ring	NBR
Ingress Protection Rating	IP 68 - 5 Bar, 30 min	
Flammability	V2 according to UL94	
Operating Temperature	Permanent	-20 °C to +100 °C
	Intermittent	-40 °C to +150 °C
Thread Type	<ul style="list-style-type: none"> • Metric EN 60423 • PG DIN 40430 • NPT ANSI B1.20.1 • Other thread types also available upon request. 	
Cable Type	Non armoured	
Accessories	<ul style="list-style-type: none"> • Lock nuts • Dome plugs • Reducing seals • Flat cable seals • Multihole seals • Gaskets (Washers) 	
	<ul style="list-style-type: none"> • Different Seal types available. • Manufactured according to DIN EN 62444/50262. • We recommend the use of lock nuts and gaskets to ensure IP rating for rough surfaces or through holes. • Some approvals do not cover all sizes. • Accessories must be ordered separately. • Some approvals do not cover all sizes. • O-ring available in Metric and PG threads as a standard. For NPT threads O-ring available upon request. 	
Remarks	<p>Note: Applications of most cable glands don't require same parameters applied to tests. For applications strictly acc. to the approval definitions please consult data sheet.</p>	
Approvals	Certificate Number	Standards
	40040034	DIN EN 62444
	E199260	UL514B CSA22.2 No 18.3-12 CSA22.2 No 94.2-1S
		UL50E
TYPE 4x		
	E-14047	EN62444

For more approvals: see our webpage.



Order Coding				
Part Number	-	Gasket (Washer)	Lock Nut	Sealing Plug
Mandatory	-	Option	Option	Option
See table	-	WC Chloroprene WS Silicone	L Lock Nut	P Dome Plug T Dust Plug
Example	-	WC	L	P
BMSD-04	-	WC	L	P

Standard Cable Glands with Thread, Stainless Steel

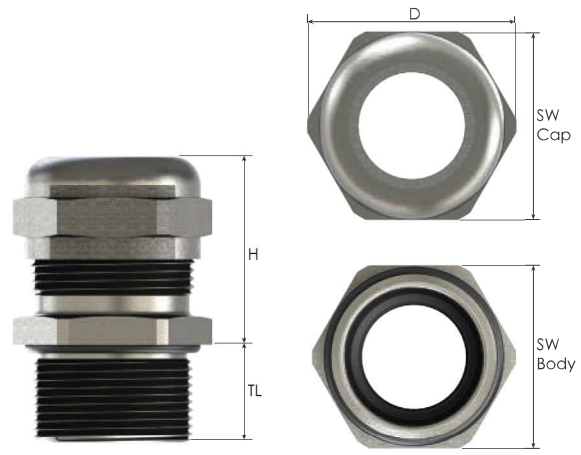

Thread Type **METRIC** acc. to EN 60423

Outer Thread Size (Male)	Clamping Range Ø min-max mm	Outer Thread Length TL mm	Spanner Width		Outer Ø D mm	max. Height		Part Number	Minimum Order Quantity
			Cap mm	Body mm		H mm			
M12x1,5	2,0 - 5,0	6,0	14	14	15,5	24,0		BMSD-0S	1000
	2,0 - 5,0	12,0	14	14	15,5	24,0		BMSE-0SR	1000
	3,0 - 6,5	6,0	14	14	15,5	24,0		BMSC-0S	1000
	3,0 - 6,5	12,0	14	14	15,5	24,0		BMSE-ES	1000
M16x1,5	2,0 - 6,0	7,0	17	19	21,0	25,5		BMSD-01	900
	2,0 - 6,0	12,0	17	19	21,0	25,5		BMSE-01R	900
	3,0 - 7,0	7,0	22	22	24,5	30,5		BMSD-E1	600
	3,0 - 7,0	12,0	22	22	24,5	30,5		BMSE-E1R	600
	4,0 - 8,0	7,0	17	19	21,0	25,5		BMSC-01	900
	4,0 - 8,0	12,0	17	19	21,0	25,5		BMSE-01	900
	5,0 - 10,0	7,0	22	22	24,5	30,5		BMSC-E1	600
	5,0 - 10,0	12,0	22	22	24,5	30,5		BMSE-E1	600
M20x1,5	5,0 - 9,0	8,0	22	22	24,5	26,5		BMSD-02	500
	5,0 - 9,0	12,0	22	22	24,5	28,0		BMSE-E2R	500
	6,0 - 12,0	8,0	22	22	24,5	26,5		BMSC-02	500
	6,0 - 12,0	12,0	22	22	24,5	28,0		BMSE-E2	500
	7,0 - 13,0	8,0	24	24	26,5	30,5		BMSC-E2S	350
	10,0 - 14,0	8,0	24	24	26,5	30,0		BMSC-02S	350
	10,0 - 14,0	12,0	24	24	26,5	30,0		BMSE-02S	350
M25x1,5	7,0 - 12,0	8,0	24	27	30,0	30,0		BMSD-03	350
	7,0 - 12,0	12,0	24	27	30,0	30,0		BMSE-03R	350
	9,0 - 16,0	8,0	30	30	33,0	35,0		BMSD-03S	200
	9,0 - 16,0	12,0	30	30	33,0	35,0		BMSE-03SR	200
	10,0 - 14,0	8,0	24	27	30,0	30,0		BMSC-03	350
	10,0 - 14,0	12,0	24	27	30,0	30,0		BMSE-03	350
	11,0 - 17,0	8,0	27	27	30,0	32,5		BMSC-E3	350
	11,0 - 17,0	12,0	27	27	30,0	32,5		BMSE-E3	350
	13,0 - 18,0	8,0	30	30	33,0	35,0		BMSC-03S	200
	13,0 - 18,0	12,0	30	30	33,0	35,0		BMSE-03S	200
	M32x1,5	9,0 - 16,0	9,0	30	36	39,8	35,0		BMSD-04
9,0 - 16,0		15,0	30	36	39,8	35,0		BMSE-04R	200
12,0 - 20,0		9,0	41	41	45,5	39,5		BMSD-04S	100
12,0 - 20,0		15,0	41	41	45,5	39,5		BMSE-04SR	100
13,0 - 18,0		9,0	30	36	39,8	35,0		BMSC-04	200
13,0 - 18,0		15,0	30	36	39,8	35,0		BMSE-04	200
15,0 - 21,0		8,0	36	36	39,8	38,0		BMSC-E4	200
15,0 - 21,0		15,0	36	36	39,8	38,0		BMSE-E4	200
18,0 - 25,0		9,0	41	41	45,5	39,5		BMSC-04S	100
18,0 - 25,0		15,0	41	41	45,5	39,5		BMSE-04S	100
M40x1,5	12,0 - 20,0	9,0	41	46	51,4	40,5		BMSD-05	100
	12,0 - 20,0	15,0	41	46	51,4	40,5		BMSE-05R	100
	16,0 - 23,0	9,0	46	46	51,4	45,5		BMSD-E5	100
	16,0 - 23,0	15,0	46	46	51,4	45,5		BMSE-E5R	100
	19,0 - 28,0	9,0	46	46	51,4	45,5		BMSC-E5	100
	19,0 - 28,0	15,0	46	46	51,4	45,5		BMSE-E5	100
	18,0 - 25,0	9,0	41	46	51,4	40,5		BMSC-05	100
	18,0 - 25,0	15,0	41	46	51,4	40,5		BMSE-05	100
	22,0 - 32,0	9,0	50	50	55,5	51,0		BMSC-05S	50
22,0 - 32,0	15,0	50	50	55,5	51,0		BMSE-05S	50	
M50x1,5	20,0 - 26,0	9,0	50	55	61,0	50,0		BMSD-06	50
	20,0 - 26,0	15,0	50	55	61,0	50,0		BMSE-06R	50
	22,0 - 32,0	9,0	50	55	61,0	50,0		BMSC-06	50
	22,0 - 32,0	15,0	50	55	61,0	50,0		BMSE-06	50
	27,0 - 38,0	9,0	60	60	66,5	54,0		BMSC-E6	40
	27,0 - 38,0	15,0	60	60	66,5	54,0		BMSE-E6	40
	34,0 - 44,0	9,0	65	65	71,0	55,0		BMSC-06S	40
	34,0 - 44,0	15,0	65	65	71,0	55,0		BMSE-06S	40
M63x1,5	29,0 - 35,0	10,0	65	70	77,0	56,0		BMSD-E7	40
	29,0 - 35,0	14,0	65	70	77,0	55,0		BMSD-07	40
	29,0 - 35,0	18,0	65	70	77,0	55,0		BMSE-07R	40
	34,0 - 44,0	10,0	65	70	77,0	56,0		BMSC-E7	40
	34,0 - 44,0	14,0	65	70	77,0	55,0		BMSC-07	40
	34,0 - 44,0	18,0	65	70	77,0	55,0		BMSE-07	40
	37,0 - 53,0	10,0	75	75	83,0	53,0		BMSC-07S	20
	37,0 - 53,0	18,0	75	75	83,0	53,0		BMSE-07S	20