

## Plug XL-410

In-line, Ø 4 mm, with spring-loaded MULTILAM, for self-assembly of test leads.

With rigid insulating sleeve. **Screw connection.**

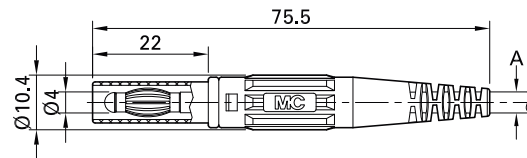

Order No.	Type	Rated voltage/current	Cable (A)			*Standard colors										
66.9196-*	XL-410	1000 V, CAT II / 32 A 600 V, CAT III / 32 A	max. Ø 3.9 mm	max. 2.5 mm <sup>2</sup>	Ni	<table border="1"> <tr> <td>21</td> <td>22</td> <td>23</td> <td>24</td> <td>25</td> </tr> <tr> <td>26</td> <td>27</td> <td>29</td> <td></td> <td></td> </tr> </table>	21	22	23	24	25	26	27	29		
21	22	23	24	25												
26	27	29														



Assembly instructions MAH503

[www.staubli.com/electrical](http://www.staubli.com/electrical)



Optional colors 20

Further information, page 6

## Plug SLS425-SW...

Right-angled, Ø 4 mm, with spring-loaded MULTILAM, for self-assembly of test leads. With rigid insulating sleeve. Nickel-plat-

ed and gold-plated versions available. **Solder connection.**

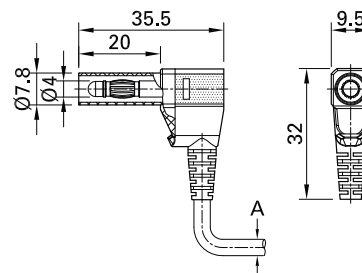

Order No.	Type	Rated voltage/current	Cable (A)			*Standard colors										
22.2667-*	SLS425-SW	500 V, CAT II / 32 A	max. 3.9 mm	max. 2.5 mm <sup>2</sup>	Ni	<table border="1"> <tr> <td>20</td> <td>21</td> <td>22</td> <td>23</td> <td>24</td> </tr> <tr> <td>25</td> <td>26</td> <td></td> <td></td> <td></td> </tr> </table>	20	21	22	23	24	25	26			
20	21	22	23	24												
25	26															
22.2668-*	SLS425-SW/A	500 V, CAT II / 32 A	max. 3.9 mm	max. 2.5 mm <sup>2</sup>	Au	<table border="1"> <tr> <td>21</td> <td>22</td> <td></td> <td></td> <td></td> </tr> </table>	21	22								
21	22															

### Component parts

22.2370-*	KT425-SW	Insulator (*Standard colors see SLS425-SW)
22.1042	LS425-SW	Plug suitable for: SLS425-SW
22.1045	LS425-SW/A	Plug suitable for: SLS425-SW/A



Assembly instructions MA107

[www.staubli.com/electrical](http://www.staubli.com/electrical)



Optional colors 20 23 24 25 26

Further information, page 6